

Dual Temp Plus Infrared Thermometer W/Laser

Operating Instructions

The Dual Temp Plus thermometer offers infrared and multiple probe capabilities. Fully review all instructions as this unit offers many mathematical and memory functions. Please keep away from children and **DO NOT** use for safety related applications.

1. Sensor
2. Laser
3. Battery Compartment (2 AAA)
4. Thermocouple Socket
5. MEAS. Button
6. Battery Cover
7. LCD Display
8. SELECT, UP and DOWN Buttons

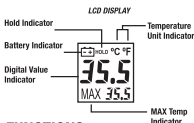
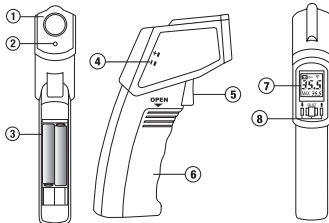

FUNCTIONS:

Press the **SELECT** button to scroll through the following:

E, Δ EV, MAX, MIN, DIF, AVG, HAL, LAL, PRB

EMISSIVITY:

Select **E** to display emissivity.



Note: Default emissivity setting is .95 which will be applicable to most common material surface. Further emissivity uses can be checked on a published list.

Select **Δ EV**, followed by the **UP** and **DOWN** button to set the emissivity levels. Continue by pressing the **SELECT** button to confirm your setting in the memory. The emissivity can be changed from .10 (10E) to 1 (100E).

MAX, MIN, DIF or AVG Temperature Measurement:

Press the **SELECT** button to view the desired function. Press and hold the **MEAS.** button and start scanning.

HAL, LAL:

Alarms can be set on this unit as warnings or notice of certain temperatures. Simply press the **SELECT** button several times and scroll until you view (HAL), High Alarm Level and (LAL), Low Alarm Level on your screen. Once on either function, you can press the **UP** and **DOWN** buttons to lower or raise the desired alarm temperature. Once these numbers are set your unit will sound an alarm if these parameters are reached or passed.

PRB:

To use your probe or surface temp. wire, simply scroll with the **SELECT** button until you can view the (PRB) or probe function on your screen. Plugging the Thermocouple into the Thermocouple Socket will automatically activate your probe or surface temp. wire. The unit will display the surface temperature in the lower right corner of the screen. The unit is also capable of measuring with the infrared while in the (PRB) mode, offering both surface and laser readings simultaneously.



Note: Surface and laser readings may differ due to the emissivity!



Note: To see the Minimum or Maximum data while in the (PRB) mode, press and hold the UP or DOWN button.

Simply aim the thermometer at the measuring target and press the **MEAS.** button to display the surface temperature.

The Distance Spot is 30 : 1. Make sure the target area is within the field of view.

°F or °C	Press the DOWN button to switch display between °F and °C (only in E, MAX, MIN, DIF, AVG modes.)
Backlight	Hold down the MEAS. button and press the UP button at the same time to activate the backlight.

Laser:

Hold down the **MEAS.** button and press the **DOWN** button at the same time to turn the laser ON or OFF.



Note: Non-contact infrared thermometers are not recommended for use in measuring the temperature of shiny or polished metals.

The thermometer will automatically shut off if left to idle for more than 60 sec, unless in **PRB mode. (In **PRB** mode, it will shut off if left idle for more than 9 minutes.)



ATTENTION!

- **DO NOT look directly into the laser beam, Permanent eye damage may result.**
- **Use extreme caution when operating the laser!**
- **Never point the device towards anyone's eyes!**
- **Keep out of reach of children!**

STORAGE & CLEANING

The sensor lens is the most delicate part of the thermometer. The lens should be kept clean at all times. Care should be taken when cleaning the lens using only a soft cloth or cotton swab with water or medical alcohol. Allow the lens to fully dry before using the thermometer. Do not submerge any part of the thermometer. Store thermometer at room temperature.

LCD ERROR MESSAGES



HI or **LO** is displayed when the temperature being measured is outside of the settings of (HAL) High Alarm Level and (LAL) Low Alarm Level.



For all other error messages it is necessary to reset the thermometer. To reset, turn the instrument off, remove the battery and wait for a minimum of one minute. Reinsert the battery and turn on. If the error message remains please contact the Service Department for further assistance.

BATTERY REPLACEMENT

(Remember to power off the unit before replacing the battery).



BATTERY OK



BATTERY LOW



BATTERY EXHAUSTED



When the Low Battery icon displays, the batteries should be replaced. (AAA batteries – 2 pcs.)



Dispose of used battery promptly and keep away from children.

SPECIFICATIONS	52225-A	52224-B
Non-Contact Temp. Range	-76° to 1400°F (-60° to 760°C)	-76° to 1200°F (-60° to 648°C)
Thermocouple Temp. Range	-83.2° to 1999°F (-64° to 1400°C)	
Full Range Accuracy	±2% of reading or 2°C (4°F) whichever is greater	
Thermocouple Probe Accuracy:	±1% of reading or 1°C (1.8°F) whichever is greater	
Resolution	0.1°F (0.1°C)	
Reponse Time (90%)	1 second	15 : 1
Distance : Spot	30 : 1	
Battery Life	Typically 180 hrs, Minimally 140 hours continuous use (Alkaline, without Laser and Back Light)	
Dimensions	7.5 x 1.5 x 4.5" (190.5 x 38 x 114mm)	
Weight (Including batteries)	.42 oz (11.9 grams)	